



Pod Factory + Arch Leisure

---

# Wedding Venue Accomodation

---



# Wedding Venue - Accommodation

Many wedding venues generate accommodation demand for local bed/ breakfast and hotels etc.. We have supplied a number of these venues with their own hotel style accommodation.

Below you will see 3 sample layouts which show some quality options to entice your guests to stay on site. One of our customers has even created a honeymoon suite and is offering this at a premium rate to the bride and groom.

Each of these rooms has space for a luxury king size bed, Tea station with Fridge and coffee making equipment and spacious bathroom facilities.

Whether its for a one night stay or a short break this is quality accommodation options which will command premium rates and great return on investment all year round.

# The Standard Range

Standard range of Wedding venue pods.

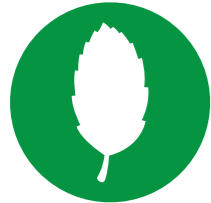

6.6/4m 2 berth Model

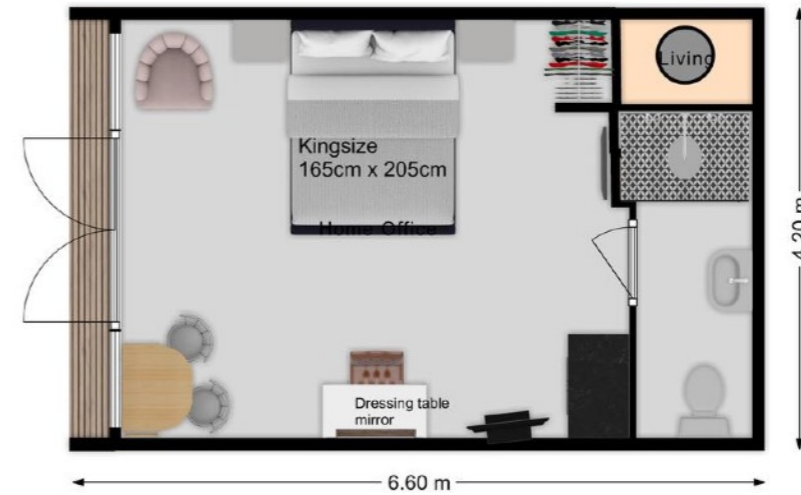

8/4m 2 berth Model

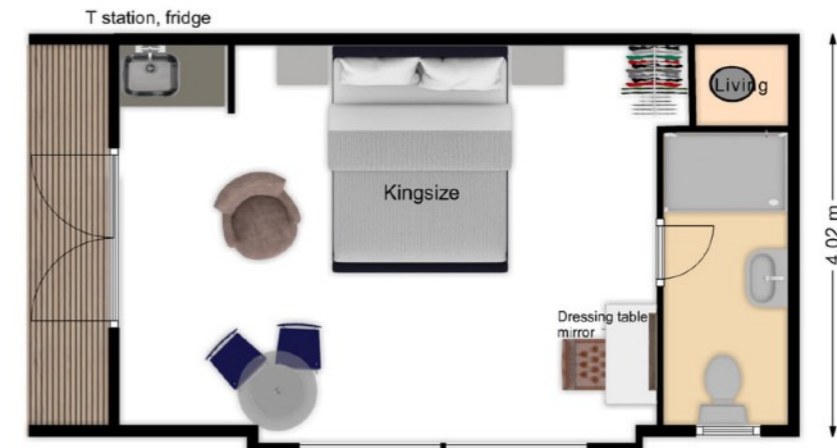

9/4m 4 berth Model

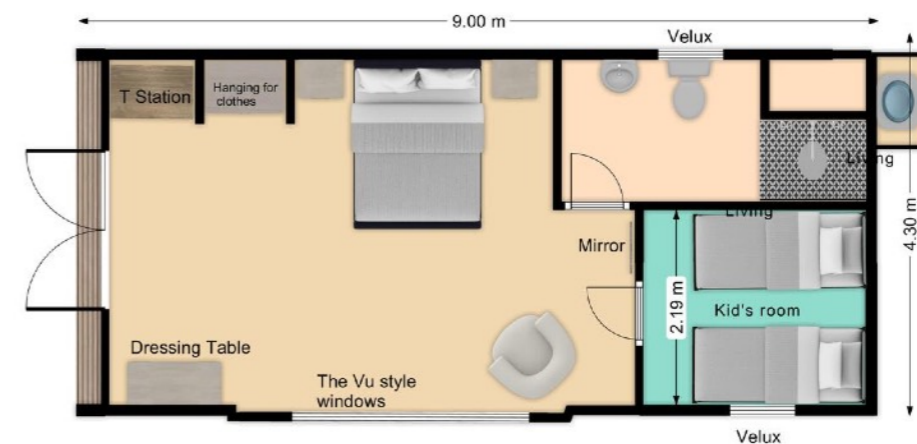

\*\*\*Bespoke options can be made available on request. \*\*\*

Construction Spec	Info
Walls	120mm LVL laminated frame with 100mm insulation
Roof	120mm LVL laminated frame with 100mm insulation
Floor	120mm LVL laminated frame with 100mm insulation
Optional extra	Multi foil external insulation equivalent to 60mm
<b>External specification</b>	
Chassis spec	Heavy duty chassis. Large 200/100/5mm Main members with 125/60mm Outriggers.
External cladding	-Larch cladding machined with hidden fixings. 18/125mm -Optional extra Canexel Low maintenance cladding
External Roof covering	-Metrotile exterior. Colour TBC
<b>Internal Specification</b>	
Kitchen	Tea station with solid Oak worktops
Bathrooms	1 x 1200mm Shower, bespoke vanity unit, standard toilet.
Internal boards	MDF internal v groove Cladding
Internal flooring	LVL flooring (Colour TBC)
Windows and doors	UPVC Panoramic doors
Internal doors	Holdenby Oak internal doors. Finished with OSMO treatment.
<b>Electrical</b>	
All electrics installed.	
Sockets and switches	Brushed chrome switches and sockets with USB by the beds.
Lighting	All internal lighting warm white spot lights and external LED lighting.
Heating	Electric radiator heating throughout.
<b>Plumbing</b>	
All plumbing installed and tested by gas safe engineer. All heat loss calculations will be supplied. All pipe work to be N pressed fittings.	
Boiler/ Water heating	120l Expansion tank installed
Total Price:	£33,500.00 + 5% VAT
Delivery estimate:	On request

# 6.6/4.2 Pod

## Front entry 2 Berth Pod

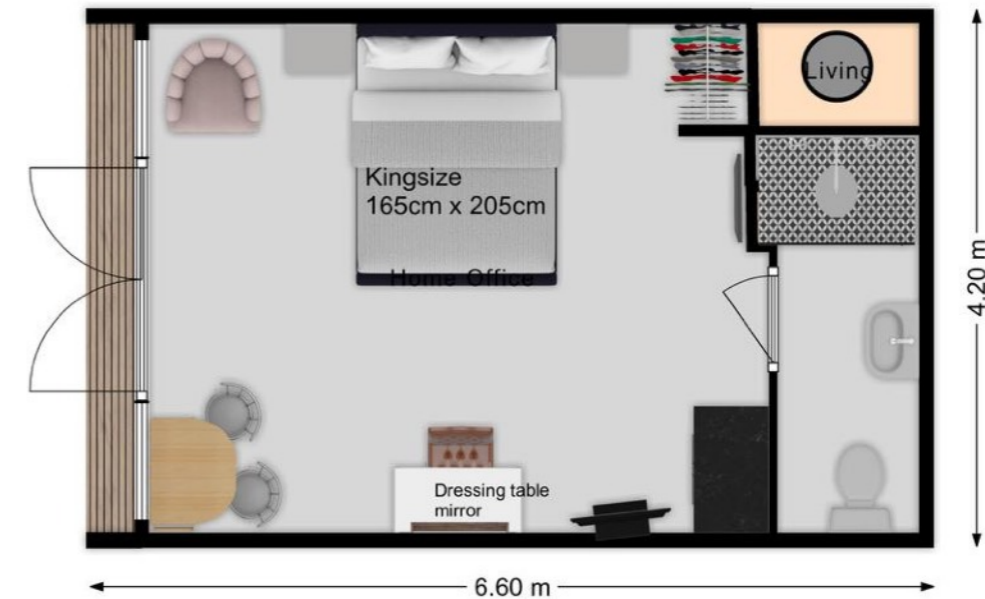

Construction Spec	Info
Walls	120mm LVL laminated frame with 100mm insulation
Roof	120mm LVL laminated frame with 100mm insulation
Floor	120mm LVL laminated frame with 100mm insulation
Optional extra	Multi foil external insulation equivalent to 60mm
<b>External specification</b>	
Chassis spec	Heavy duty chassis. Large 200/100/5mm Main members with 125/60mm Outriggers.
External cladding	-Larch cladding machined with hidden fixings. 18/125mm -Optional extra Canexel Low maintenance cladding
External Roof covering	-Metrotile exterior. Colour TBC
<b>Internal Specification</b>	
Kitchen	Tea station with solid Oak worktops
Bathrooms	1 x 1200mm Shower, bespoke vanity unit, standard toilet.
Internal boards	MDF internal v groove Cladding
Internal flooring	LVL flooring (colour TBC)
Windows and doors	UPVC French doors, 2.6/2.1m Viewing window.
Internal doors	Holdenby Oak internal doors. Finished with OSMO treatment.
<b>Electrical</b>	
All electrics installed.	
Sockets and switches	Brushed chrome switches and sockets with USB by the beds.
Lighting	All internal lighting warm white spot lights and external LED lighting.
Heating	Electric radiator heating throughout.
<b>Plumbing</b>	
All plumbing installed and tested by gas safe engineer. All heat loss calculations will be supplied. All pipe work to be N pressed fittings.	
Boiler/ Water heating	120l Expansion tank installed
<b>Total Price:</b> £37,500.00 + 5% VAT	
<b>Delivery estimate:</b> On request	

# 8/4m

## Front entry 2 Berth Pod

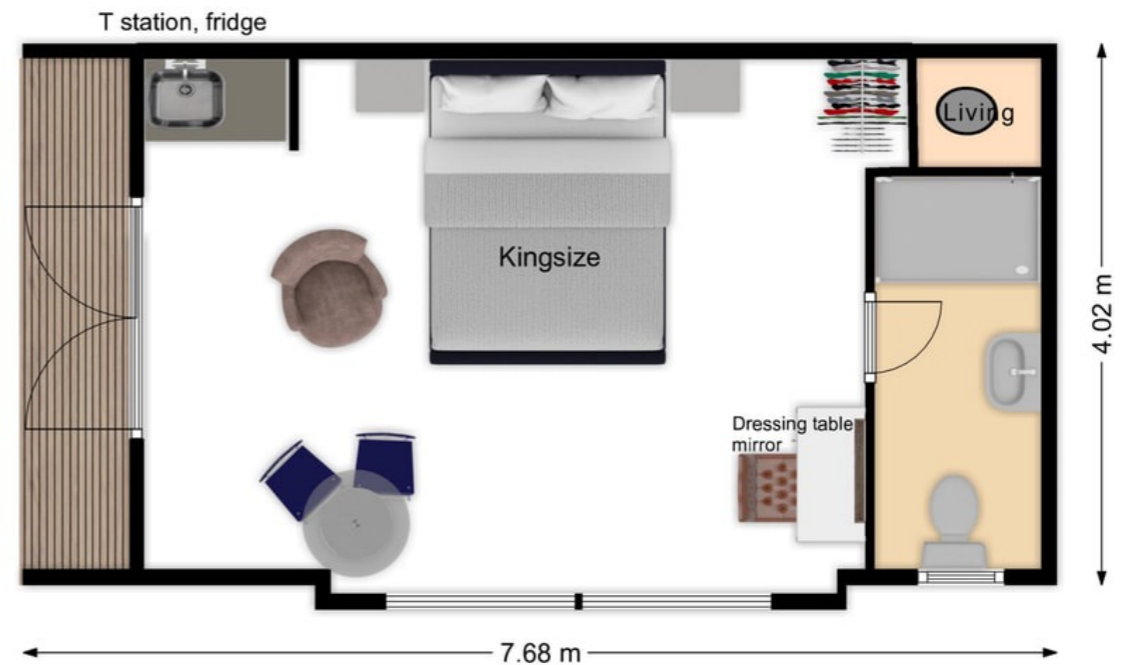

Construction Spec	Info
Walls	120mm LVL laminated frame with 100mm insulation
Roof	120mm LVL laminated frame with 100mm insulation
Floor	120mm LVL laminated frame with 100mm insulation
Optional extra	Multi foil external insulation equivalent to 60mm
<b>External specification</b>	
Chassis spec	Heavy duty chassis. Large 200/100/5mm Main members with 125/60mm Outriggers.
External cladding	-Larch cladding machined with hidden fixings. 18/125mm -Optional extra Canexel Low maintenance cladding
External Roof covering	-Metrotile exterior. Colour TBC
<b>Internal Specification</b>	
Kitchen	Tea station with solid Oak worktops
Bathrooms	1 x 1200mm Shower, bespoke vanity unit, standard toilet.
Internal boards	MDF internal v groove Cladding
Internal flooring	LVL flooring (colour TBC)
Windows and doors	UPVC French doors, 2.6/2.1m Viewing window.
Internal doors	Holdenby Oak internal doors. Finished with OSMO treatment.
<b>Electrical</b>	
All electrics installed.	
Sockets and switches	Brushed chrome switches and sockets with USB by the beds.
Lighting	All internal lighting warm white spot lights and external LED lighting.
Heating	Electric radiator heating throughout.
<b>Plumbing</b>	
All plumbing installed and tested by gas safe engineer. All heat loss calculations will be supplied. All pipe work to be N pressed fittings.	
Boiler/ Water heating	120l Expansion tank installed
<b>Total Price:</b> £39,950.00+ 5% VAT	
<b>Delivery estimate:</b> On request	

# 9/4.2m Pod

## Side entry 4 berth Pod

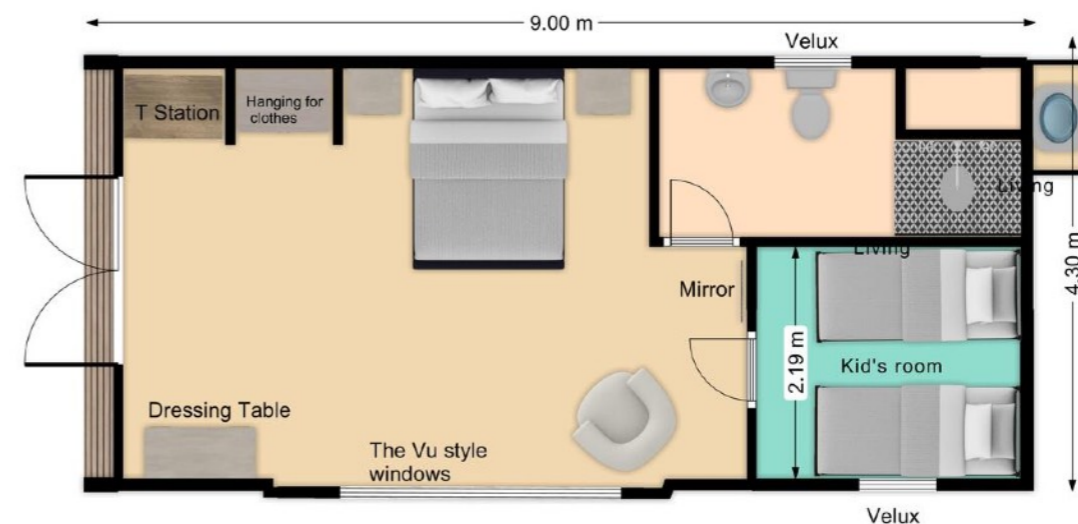



Pod Factory + Arch Leisure

# Wedding Venue Accommodation



Pod Factory + Arch Leisure

# Wedding Venue Accommodation





Pod Factory + Arch Leisure

# Wedding Venue Accommodation

# Contact us

Contact number:

Alex Mobile: 07891502539

Keith Mobile: 07779 311883

Sales office: 0115 828 4918

Email:

[alex@podfactory.co.uk](mailto:alex@podfactory.co.uk)

[keith@Archleisure.co.uk](mailto:keith@Archleisure.co.uk)

Website:

[www.podfactory.co.uk](http://www.podfactory.co.uk)

[www.archleisure.co.uk/](http://www.archleisure.co.uk/)

